

■ TISA Automatic Sealer
Spare Parts **DIAGRAM**

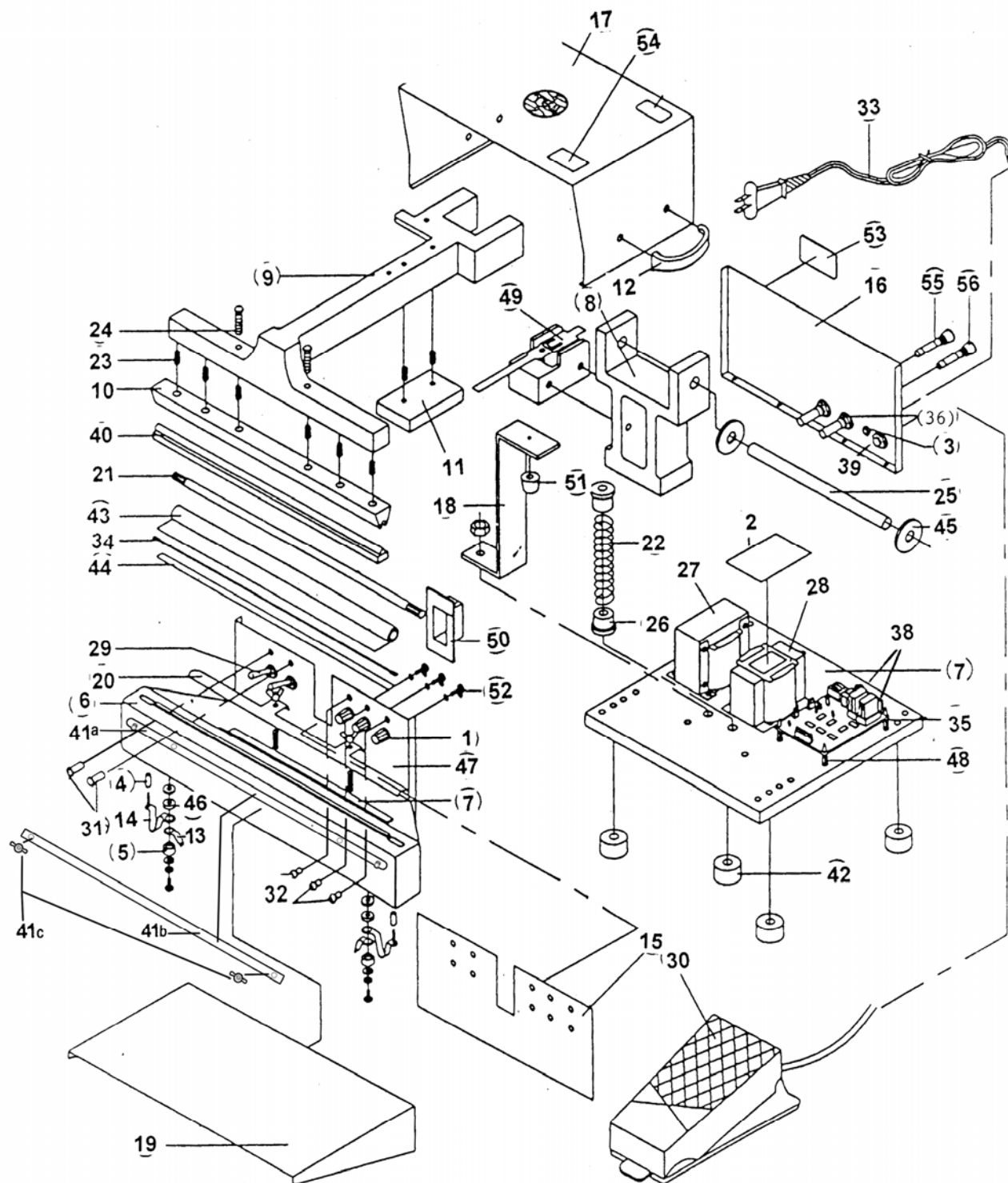

■ TISA Automatic Sealer

Spare Parts LIST

No.	Description				
1	Timer Knob / Sealing	TISA-1	31a	Signal Light, White	TISA-31a
2	Plastic Plate	TISA-2	31b	Signal Light, Green	TISA-31b
3	Bushing / Power Cord	TISA-3	31c	Signal Light, Red	TISA-31c
4	Bakelite Pipe	HA-2	31d	Signal Light, Orange	TISA-31d
5	Conv ex Bakelite, Black	HA-6	32	LED Light, Red	TISA-32
6	Lower Jaw		32a	LED Light, Yellow	TISA-32a
7	Base Plate		33	Power Cord	PC-TEW
8	Hinge Bracket, T-Type		34	Heating Element, 2mm, Round	
9	Upper Jaw		34a	Heating Element, 5mm	
10	Upper Jaw Suppor, SR Holder		35	Control, PC Board, Complete	PCB-TISA
	Sealing Press Arm, Complete w/ #9,10,40		36	Fuse Bracke, Holder, Fuse Block	TISA-36
11	Flat Plate, Magnet	TISA-11	37	PCB Transformer, Older Model	
12	Handle Strap	TISA-12	38	PCB Relay, 771-S-1C, Old Model	
13	Brass Contact, Lead, PR-08	HA-5	39	Connector for Foot Switch/Rear of Sealer (F)	TISA-39
14	Mounting Spring	MS-TEW	40	Pressure Pad, Silicone Rubber	
14a	Screw/washer for Mounting Spring / 455 / 655		41	Rubber String	
14b	Tension, Mounting Spring w/ Bakelite		41a	Plate for Teflon Cover Pressing, Plate Front	
14C	Heater Terminal Assembly	HTA-TEW	41b	Teflon Cover Pressing Plate	
15	Front Plate		41c	Wing Nut	TISA-41c
16	Back Plate		42	Rubber Foot	TISA-42
17	Top Cover Plate		43	Upper Barrier Cloth	
18	Spring Level, Z-Type		44	Bottom Barrier Tape	
19	Operating Board		45	Pin Washer	TISA-45
20	Clip for Cloth, Rear / Tefon Cover Plate		46	Insulator Washer	HA-3
21	Screw for Cloth, Teflon Roller		47	Control Panel Label	
22	Return Spring	TISA-22	48	PC Board Support, White	TISA-48
23	Spring for Upper Jaw, Pressure Spring	TISA-23	49	Microswitch	MSW-TISA
24	Screw for Upper Jaw		50	Rubber Frame	TISA-50
24a	Upper Jaw Insulator	TISA-24a	51	Rubber Stop	TISA-51
25	Hinge Pin	TISA-25	52	Potentiometer	TISA-52
26	Spring Bracket	TISA-26	53	Name Plate	
27	Transformer		54	Instruction Label	
27a	Transformer L Bracket w/ 4 screws& nuts (Old Model)	TISA-27a	55	Fuse 10A, (2mm)	
28	Solenoid		56	Fuse 1A, (2mm, 5mm)	TISA-56
29	Toggle Switch, 4 P	TISA-29	57	Fuse 20A, (5mm)	
30a	Foot Switch, 10A, SPS-222	FSW-TEW	58	Copper Insulator / Element	
30b	Foot Switch, 15A, SPS-337	FSW-TEW-HD	59	CU Seat for Hinge	
30c	Connector at end of Foot Switch Cord (M)	TISA-30c	75	Felt Same as TISF	TISF-75
30d	Microswitch for Foot Switch	MSW-TEW			